

Dimension:
Unit=mm

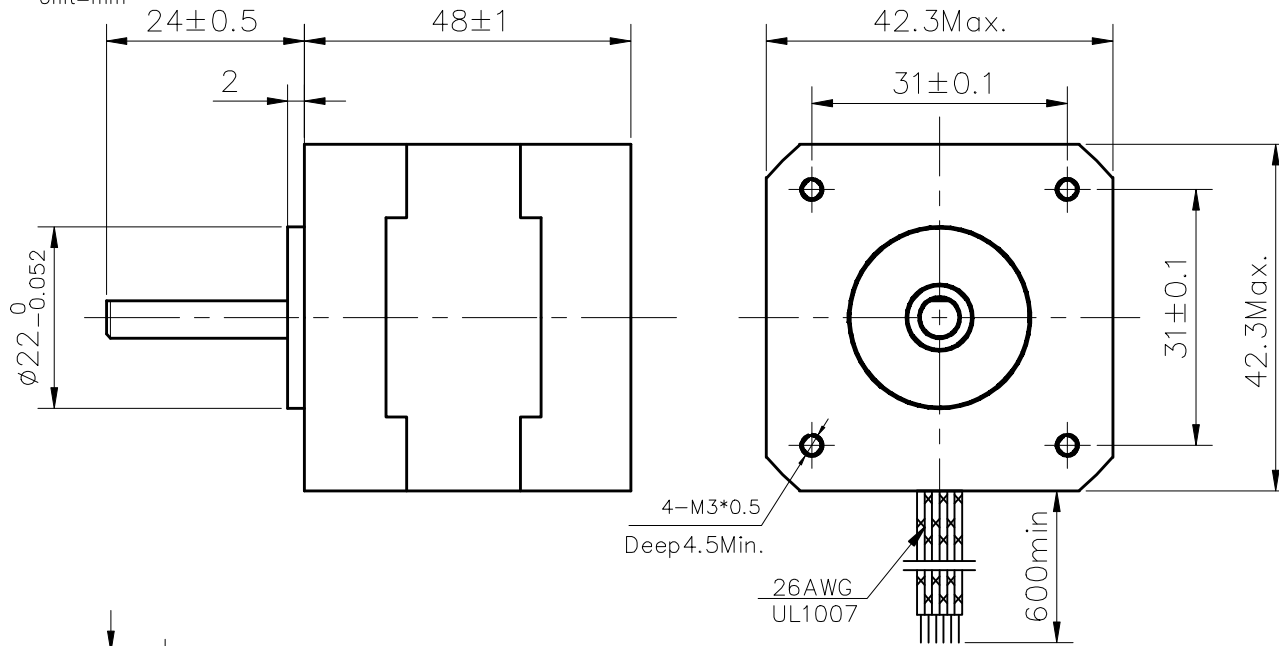

Wiring Diagram:

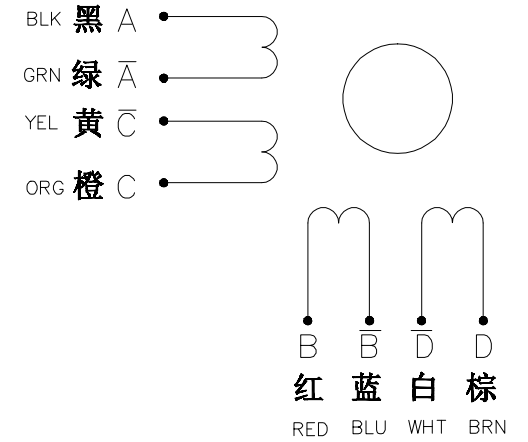

Specifications:

相数	Phase	4	Comment	
步距角	Step Angle	1.8	deg.	
电压	Voltage	4.6	V	
相电流	Current	1.0	A	
相电阻	Resistance	4.6±10%	Ω	
相电感	Inductance	4.0±20%	mH	
静力矩	Holding Torque	3.4	kg.cm	
绝缘等级	Insulation Class	B		
重量	Mass	0.34	kg	

REV.	QTY.	No.	SIG.	DATE	Title:			42HS0348
					Specification			
DESIGN	蔡金龙	18.5.11	STD.		CLS.MAK	WEIGHT	SCALE	
CHECK								
PROC.			APPR.		PAGE: OF PAGES			